

GLASS DOOR LOCK

GS-GL3

LOCKS



- Cylinder lock designed for glass showcases.
- GS-GL3 lock is compatible with GS-GH5 hinge.
- Thick deadbolt provides added security and quick, easy installation, the only drilling required is a round hole.
- Locking direction can be changed by turning the case lock and cylinder.
- 360° key rotation.
- Maximum 120 key changes.
- Key removable when unlocked. Key not removable when unlocked is also available.
- Key not removable option allows key to be used as a pull or knob.
- Strike plate acts as a door stopper for stable locking operation.

Application	Door Material	Key Changes	Master Key	When Unlocked	Total Lock
Single Swing Door	Glass	120	-	R: Key Removable	2650 Series*
				NR: Key Is Not Removable	

*Only compatible with 2650 models for 22 mm & 30 mm thickness boards. GS-GL3 key is not accessible for 16 mm board thickness

Round Dead Bolt



Only processing required for boards is a $\phi 10$ mm drilling.

Cut Out Dimensions Tempered Glass

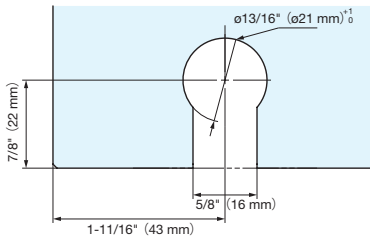

Cut Out Dimensions (Dead bolt direction: down)

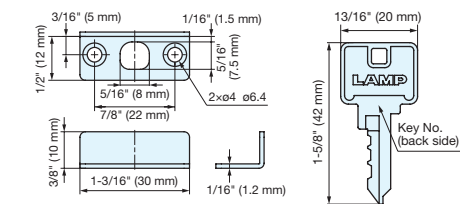
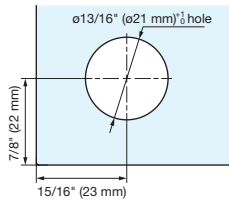

Change Locking Direction

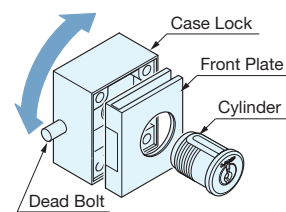

1. Remove the cylinder from the front plate.
2. Turn the case lock and front plate to the desired direction.
3. Fix them with nuts or screws.
(Make sure the LAMP logo on the cylinder is always in the right direction.)

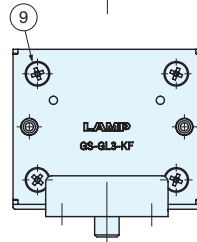
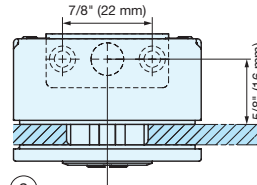

Installation Example Left-side Locking

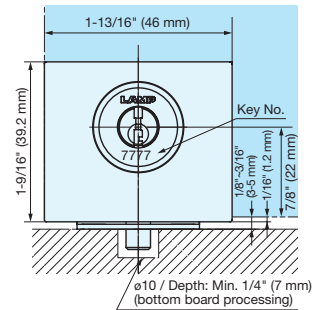
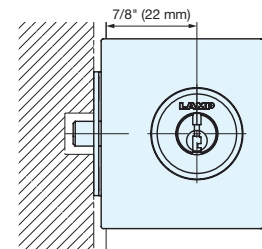

No.	Part Name	Material	Finish		
			CR	GP	BL
①	Cylinder	Zinc Alloy (ZDC)	Chrome	Gold Plated (24K)	Black Chrome
②	Front Plate		Enamel Black		Enamel Black
③	Case Lock	Steel (SPCC)	Enamel Black		
④	Back Plate		Clear Zinc Chromate		
⑤	Packing	Chloroprene Rubber (CR)	-		
⑥	Nut	Steel (SPCC)	Clear Zinc Chromate		
⑦	Dead Bolt	Steel	Nickel		
⑧	Strike Plate	Steel (SPCC)	Enamel Black		
⑨	Cross-recessed countersunk screw M3 x 20	Steel	Black Chrome		

Item No.	Finish	Key Type	When Unlocked	Key Removal	Glass Thickness	Key Rotation Angle	Box (pcs)	Carton (pcs)
GS-GL3-R-BL-KD	Black	Key Different	Key is removable	Two Areas	1/8" ~ 5/16" (5 mm - 8 mm)	360°	12	24
GS-GL3-R-BL-2921		Key Alike						
GS-GL3-R-CR-KD	Chrome	Key Different						
GS-GL3-R-CR-2921		Key Alike						
GS-GL3-R-GP-KD	Gold Plated (24K)	Key Different						
GS-GL3-R-GP-2921		Key Alike						
GS-GL3-NR-BL-KD	Black	Key Different	Key is NOT removable	One Area		90°	12	24
GS-GL3-NR-BL-2921		Key Alike						
GS-GL3-NR-CR-KD	Chrome	Key Different						
GS-GL3-NR-CR-2921		Key Alike						
GS-GL3-NR-GP-KD	Gold Plated (24K)	Key Different						
GS-GL3-NR-GP-2921		Key Alike						

GLASS DOOR LOCK